

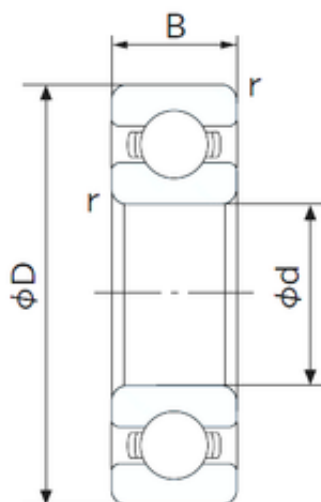

# ECU BEARING LTD



## SKF NTN NSK NMB Koyo NACHI Bearing 6201 6902 6200

Bearing No. 6201

6201 Bearing 2D drawings and 3D CAD models

Size	12x32x10 mm
Bore Diameter	12 mm
Outer Diameter	32 mm
Width	10 mm
d	12 mm
D	32 mm
B	10 mm
C	10 mm
r min.	0.6 mm
da min.	17 mm
Da max.	27 mm
ra max.	0.6 mm
Weight	0.037 Kg
Basic dynamic load rating (C)	6,8 kN
Basic static load rating (C0)	3,05 kN
(Grease) Lubrication Speed	22000 r/min
Category	Single Row Ball Bearings
Inventory	0.0
Manufacturer Name	NACHI
Minimum Buy Quantity	N/A
Weight / Kilogram	0
Product Group	B00308
Enclosure	Open
Precision Class	ABEC 1   ISO P0
Maximum Capacity / Filling	No



## ECU BEARING LTD

Slot	
Rolling Element	Ball Bearing
Snap Ring	No
Internal Special Features	No
Cage Material	Steel
Internal Clearance	C0-Medium
Inch - Metric	Metric
Long Description	12MM Bore; 32MM Outside Diameter; 10MM Outer Race Width; Open; Ball Bearing; ABEC 1   ISO P0; No Filling Slot; No Snap Ring; No Internal Special Features; C0-Medium Internal Clearance; Steel Cage
Other Features	Deep Groove
Category	Single Row Ball Bearing
UNSPSC	31171504
Harmonized Tariff Code	8482.10.50.68
Noun	Bearing
Keyword String	Ball
Manufacturer URL	<a href="http://www.nachiamerica.com">http://www.nachiamerica.com</a>
Weight / LBS	0.081
Bore	0.472 Inch   12 Millimeter
Outside Diameter	1.26 Inch   32 Millimeter
Outer Race Width	0.394 Inch   10 Millimeter
Inner Race Width	0 Inch   0 Millimeter
Bore Type	Cylindrical Bore
Configuration	Single Row
Bore Size	12 mm
Width	10 mm
Fillet Radius/Chamfer	0.6 mm
Dynamic Load Rating	6,800 N



## ECU BEARING LTD

Static Load Rating	3,050 N
Limiting Speed - Grease	22,000 rpm
Limiting Speed - Oil	28,000 rpm
Factor $f_0$	12.3
Radial Clearance	0.003 to 0.018 mm
$d_a$ (min)	17 mm
$D_a$ (max)	27 mm
$r_a$ (max)	0.6 mm